

MAT WEAVING: TOWARDS THE MÖBIUS BAND

1. Most artifacts begin with a corner, created from one strip that is folded twice at angles of 45° at the approximate midpoint of the strip so as to make a 90° change of direction each time. Note the specific movement depicted by the arrows.

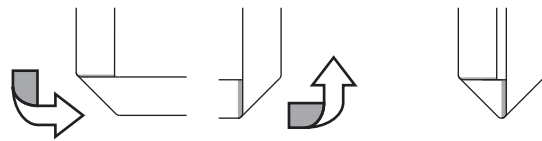

2. Weave a second strip through the first one, so as to alternate “over” and “under”, for each strip, each time.

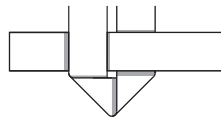

3. Fold the second strip at 90° at each side, following the folding pattern of the first strip.

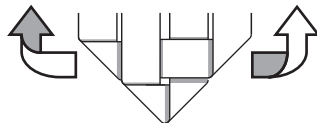

4. Weave more strips through, following the same weave and folding patterns.

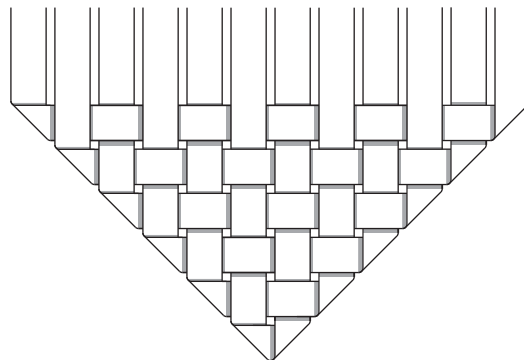

5. After weaving together 6 strips , make a choice as to whether to split the artifact into 2 arms, forming a hole in the middle, or closing it up into a square.

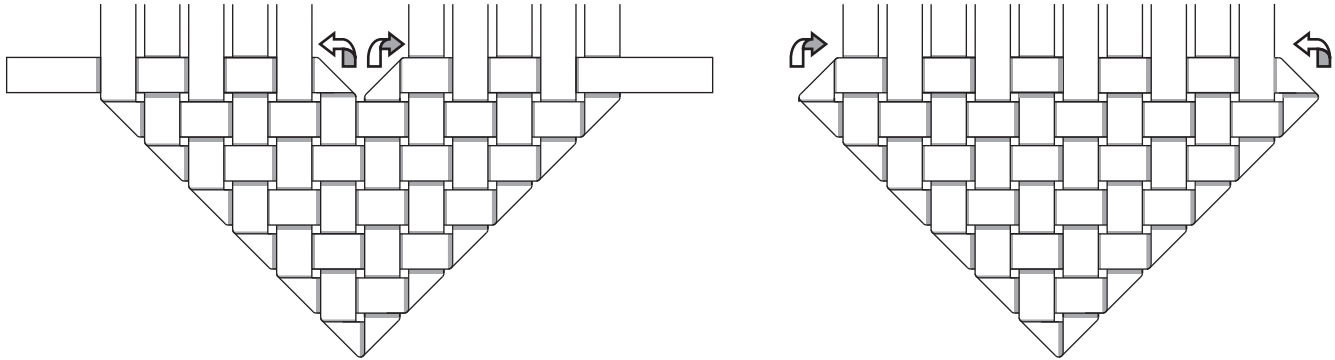

6. With the split version, the choice becomes how long to make the arms, between corners, before reconnecting, and whether to apply twists before reconnecting. For the Möbius band, apply a twist to one arm before connecting.

